

MANUFACTURED FROM FORGED PARTS

MATERIAL:

- Alloyed carburized steel at chrome-manganese 1.7131 (16MnCr5).

EXECUTION:

- Carburized, hardness.
- Surface hardness HRC 58±2 (670±40 HV30)
- Depth minimum 0,5 mm.
- Tensile strength in core minimum 800 N/mm² after carburizing.

ACCURACY:

- Taper according to DIN 254
- Taper angle:
tolerance AT 3 DIN 7178 part 1 and DIN 2080 part 1.
- Other tolerances according to DIN 7160 and 7168.
- Taper surface roughness $R_z < 0,001$ mm.

HERGESTELLT AUS GESCHMIEDETEN TEILEN

MATERIAL:

- Legierter Aufgekohlter Stahl mit Chrom-Mangan 1.7131 (16MnCr5).

KONSTRUKTIONS DATEN:

- Aufgekohlt, gehärtet und angelassen.
- Oberflächenhärte HRC 58±2 (670±40 HV30).
- Aufgekohlt auf minimum 0,5 mm Tiefe.
- Zugfestigkeit im Kern minimum 800 N/mm² nach der Aufkohlung.

GENAUIGKEIT:

- Dorn nach DIN 254.
- Kegelwinkel:
Toleranz AT 3 DIN 7178 Teil 1 und DIN 2080 Teil 1.
- Andere Toleranzen entsprechend DIN 7160 und 7168.
- Rauigkeit der Oberfläche $R_z < 0,001$ mm.

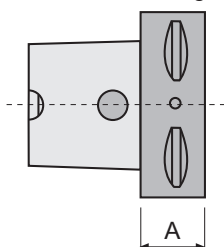

TOLERANCE AT:

- Indicates the tolerance of size D surface between the real and the theoretical value of the taper conicity.
- This value of surface D must always be less (negative), never more (positive) in order to GUARANTEE a good toolholder fixation at the bigger taper diameter.







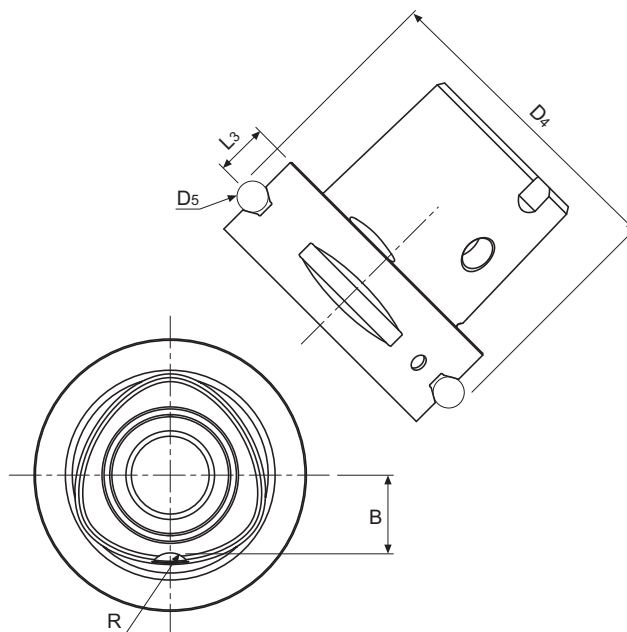
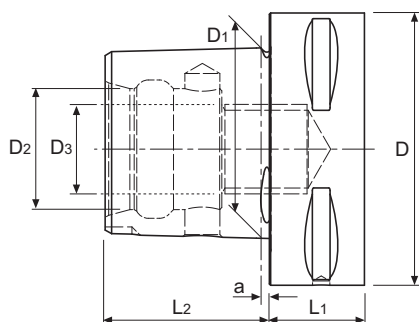





TOLERANZ AT:

- Zeigt die Toleranz auf der Messebene D zwischen dem tatsächlichen Wert der Kegelkonizität und dem theoretischen Wert.
- Dieser Wert auf der Messebene D sollte immer minus (negativ) sein, nie plus (positiv), um für einen guten Halt des Futters in den größeren Durchmesser des Kegels zu garantieren.

18 ISO 26623-1



PSC	D mm	D ₁ mm	D ₂ mm	D ₃ mm	D ₄ mm	D ₅ mm	L ₁ min mm	L ₂ mm	L ₃ mm	a mm	B mm	R mm
32	32	22	15	M12 x 1,5	39,0	5	15	19	6	2,5	9,0	3
40	40	28	18	M14 x 1,5	46,0	5	20	24	8	2,5	11,0	3
50	50	35	21	M16 x 1,5	59,3	7	20	30	10	3,0	14,0	4
63	63	44	28	M20 x 2,0	70,7	7	22	38	12	3,0	18,0	5
80	80	55	32	M20 x 2,0	86,0	7	30	48	12	3,0	22,2	6
100	100	72	43	M24 x 2,0	110,0	10	32	60	16	3,0	29,2	6

<p>18.160</p>  <p>E.02</p>	<p>18.180</p>  <p>E.03</p>	<p>18.215</p>  <p>E.04</p>	<p>18.296</p>  <p>E.05</p>	<p>18.306</p>  <p>E.06</p>
<p>18.315</p>  <p>E.07</p>	<p>18.400</p>  <p>E.08</p>	<p>18.406</p>  <p>E.09</p>	<p>18.453</p>  <p>E.10</p>	<p>18.455</p>  <p>E.11</p>
<p>18.470</p>  <p>E.12</p>	<p>18.500</p>  <p>E.13</p>	<p>18.510</p>  <p>E.14</p>	<p>18.520</p>  <p>E.15</p>	<p>18.530</p>  <p>E.16</p>
<p>18.540</p>  <p>E.17</p>	<p>18.550</p>  <p>E.18</p>	<p>18.620</p>  <p>E.19</p>	<p>18.999</p>  <p>E.20</p>	

18
PSC ISO 26623-1

20 23
JIS B 6339-BT

25
CHIRON





BORING HEADS
BOHRKÖPFE

MORSE SHANKS
MORSE SCHÄFTE

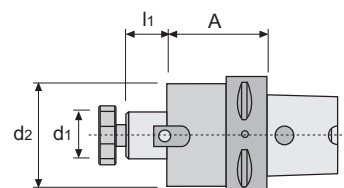



CYLINDRICAL SHANKS
ZYLINDRISCHE SCHÄFTE

ACCESSORIES
ZUBEHÖR

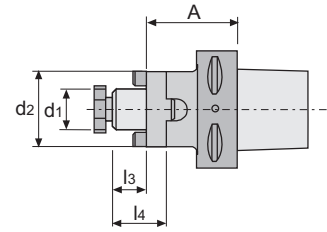

REF.	PSC	d ₁ h6 mm	A mm	l ₁ mm	d ₂ mm					
18.160.040.16	40	16	55	17	37	10008	86016	11103	-	
18.160.040.22		22	55	19	47	10010	86022	11004	-	
18.160.050.16	50	16	60	17	37	10008	86016	11103	-	
18.160.050.22		22	60	19	47	10010	86022	11004	-	
18.160.050.27		27	60	21	58	10012	86027	11005	-	
18.160.050.32		32	60	24	63	10016	86032	11105	-	
18.160.063.16	63	16	63	17	37	10008	86016	11103	-	
18.160.063.22		22	25	19	47	10010	86122	11004	-	
18.160.063.22/100		22	100	19	47	10010	86022	11004	-	
18.160.063.27		27	25	21	58	10012	86127	11005	-	
18.160.063.27/100		27	100	21	58	10012	86027	11005	-	
18.160.063.32		32	25	24	63	10016	86132	11105	-	
18.160.063.32/100		32	100	24	63	10016	86032	11105	-	
18.160.063.40		40	40	27	89	10020	80040	11006	-	
18.160.063.40/100		40	100	27	70	10020	86040	11006	-	
18.160.080.16		80	16	50	17	37	10008	86016	11103	-
18.160.080.22			22	30	19	47	10010	86122	11004	-
18.160.080.22/100	22		100	19	47	10010	86022	11004	-	
18.160.080.27	27		30	21	58	10012	86127	11005	-	
18.160.080.27/100	27		100	21	58	10012	86027	11005	-	
18.160.080.32	32		30	24	63	10016	86132	11105	-	
18.160.080.32/100	32		100	24	63	10016	86032	11105	-	
18.160.080.40	40		30	27	63	10020	86140	11006	-	
18.160.080.40/100	40		100	27	70	10020	86040	11006	-	
18.160.080.60	60		60	40	130	-	80060	11012	-	
18.160.100.16	100	16	50	17	37	10008	86016	11103	-	
18.160.100.22		22	50	19	47	10010	86022	11004	-	
18.160.100.22/100		22	100	19	47	10010	86022	11004	-	
18.160.100.27		27	50	21	58	10012	86027	11005	-	
18.160.100.27/100		27	100	21	58	10012	86027	11005	-	
18.160.100.32		32	50	24	63	10016	86032	11105	-	
18.160.100.32/100		32	100	24	63	10016	86032	11105	-	
18.160.100.40		40	50	27	63	10020	86040	11006	-	
18.160.100.40/100		40	100	27	63	10020	86040	11006	-	
18.160.100.60		60	70	40	130	-	80060	11012	-	



REF.	PSC	d ₁ h6 mm	A mm	l ₃ mm	l ₄ mm	d ₂ mm				
18.180.040.16	40	16	50	17	27	32	10008	60116	88016	-
18.180.040.22		22	50	19	31	40	10010	60122	88022	-
18.180.050.16	50	16	50	17	27	32	10008	60116	88016	-
18.180.050.22		22	50	19	31	40	10010	60122	88022	-
18.180.050.27		27	50	21	33	48	10012	60127	88027	-
18.180.050.32		32	60	24	38	58	10016	60132	88032	-
18.180.063.16	63	16	90	17	27	32	10008	60116	88016	-
18.180.063.22		22	90	19	31	40	10010	60122	88022	-
18.180.063.27		27	90	21	33	48	10012	60127	88027	-
18.180.063.32		32	90	24	38	58	10016	60132	88032	-
18.180.063.40		40	90	27	41	70	10020	60140	88040	-
18.180.080.16	80	16	100	17	27	32	10008	60116	88016	-
18.180.080.22		22	100	19	31	40	10010	60122	88022	-
18.180.080.27		27	100	21	33	48	10012	60127	88027	-
18.180.080.32		32	100	24	38	58	10016	60132	88032	-
18.180.080.40		40	100	27	41	70	10020	60140	88040	-
18.180.080.50		50	100	30	46	90	10024	60150	88050	-
18.180.100.16	100	16	100	17	27	32	10008	60116	88016	-
18.180.100.22		22	100	19	31	40	10010	60122	88022	-
18.180.100.27		27	100	21	33	48	10012	60127	88027	-
18.180.100.32		32	100	24	38	58	10016	60132	88032	-
18.180.100.40		40	100	27	41	70	10020	60140	88040	-
18.180.100.50		50	100	30	46	90	10024	60150	88050	-

18
PSC ISO 26623-1

20 23
JIS B 6339-BT

25
CHIRON

BORING HEADS
BOHRKÖPFE

MORSE SHANKS
MORSE SCHÄFTE

CYLINDRICAL SHANKS
ZYLINDRISCHE SCHÄFTE

ACCESSORIES
ZUBEHÖR

10
DIN 208011 13
DIN 69871-A16
HSK DIN 69893-117
TS ISO 26622-118
PSC ISO 26623-1

REDUCING ADAPTORS

for tools with Morse taper and tang DIN 228-B shank

REDUZIERHÜLSEN

für Werkzeuge mit Morsekegel und Austreibblappen DIN 228-B

PSC ISO 26623-1

18.215

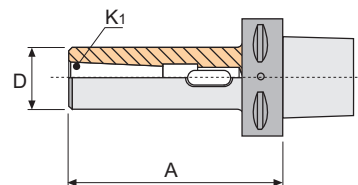

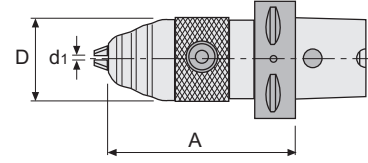

REF.	PSC	K ₁ MORSE	A mm	D mm	kg
18.215.050.02	50	2	110	32	-
18.215.050.03		3	130	40	-
18.215.063.02	63	2	110	32	-
18.215.063.03		3	130	40	-
18.215.063.04		4	150	52	-
18.215.080.03	80	3	120	40	-
18.215.080.04		4	140	52	-
18.215.080.05		5	160	63	-
18.215.100.03	100	3	130	40	-
18.215.100.04		4	150	52	-
18.215.100.05		5	175	63	-



REF.	PSC	d ₁ mm	D mm	A mm	kg
18.296.040.13	40	0.5 - 13	50	112	-
18.296.050.13	50	0.5 - 13	50	112	-
18.296.063.13	63	0.5 - 13	50	112	-
18.296.063.16		3.0 - 16	57	112	-
18.296.080.13	80	0.5 - 13	50	125	-
18.296.080.16		3.0 - 16	57	125	-
18.296.100.13	100	0.5 - 13	50	135	-
18.296.100.16		3.0 - 16	57	135	-

* SUPPLIED WITH WRENCH / * GELIEFERT MIT SCHLÜSSEL

REF.		3 x 
18.296.040.13	50706	60313
18.296.050.13	50706	60313
18.296.063.13	50706	60313
18.296.063.16	50706	60313
18.296.080.13	50706	60313
18.296.080.16	50706	60313
18.296.100.13	50706	60313
18.296.100.16	50706	60313

18
PSC ISO 26623-1

20 23
JIS B 6339-BT

25
CHIRON



BORING HEADS
BOHRKÖPFE

MORSE SHANKS
MORSE SCHÄFTE

CYLINDRICAL SHANKS
ZYLINDRISCHE SCHÄFTE

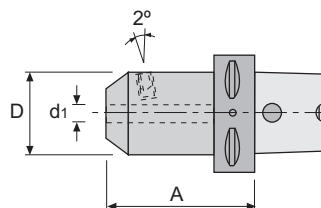
ACCESSORIES
ZUBEHÖR



REF.	PSC	d ₁ mm	D mm	A mm	2 x 	
18.306.040.06	40	06	25	50	15106	0,400
18.306.040.08		08	28	50	15108	0,400
18.306.040.10		10	35	50	15110	0,500
18.306.040.12		12	42	55	15212	0,600
18.306.040.16		16	48	55	15314	0,700
18.306.050.06	50	06	25	55	15106	0,600
18.306.050.08		08	28	55	15108	0,700
18.306.050.10		10	35	65	15110	0,700
18.306.050.12		12	42	65	15212	0,800
18.306.050.14		14	42	65	15212	0,800
18.306.050.16		16	48	65	15314	0,900
18.306.050.18		18	48	65	15314	0,900
18.306.050.20		20	52	65	15216	1,000
18.306.050.25		25	65	80	4 x 15218	1,700
18.306.063.06	63	06	25	80	15106	-
18.306.063.08		08	28	80	15108	-
18.306.063.10		10	35	80	15110	-
18.306.063.12		12	42	80	15212	1,270
18.306.063.14		14	42	80	15212	-
18.306.063.16		16	48	80	15314	1,410
18.306.063.18		18	48	80	15314	-
18.306.063.20		20	52	80	15216	1,410
18.306.063.25		25	65	90	4 x 15218	-
18.306.063.32		32	72	90	4 x 15220	2,210
18.306.063.40		40	80	95	4 x 15220	-
18.306.080.06	80	06	25	80	15106	-
18.306.080.08		08	28	80	15108	-
18.306.080.10		10	35	80	15110	-
18.306.080.12		12	42	80	15212	-
18.306.080.14		14	42	80	15212	-
18.306.080.16		16	48	80	15314	-
18.306.080.20		20	52	80	15216	-
18.306.080.25		25	65	90	4 x 15218	2,000
18.306.080.32		32	72	90	4 x 15220	2,500
18.306.080.40		40	80	110	4 x 15220	-
18.306.080.50		50	100	120	4 x 15024	-
18.306.100.12	100	12	42	100	15212	-
18.306.100.16		16	48	100	15314	-
18.306.100.20		20	52	100	15216	-
18.306.100.25		25	65	100	4 x 15218	-
18.306.100.32		32	72	100	4 x 15220	-
18.306.100.40		40	80	120	4 x 15220	-
18.306.100.50		50	100	130	4 x 15024	-

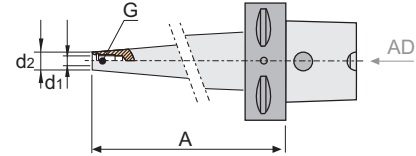

REF.	PSC	A mm	d ₁ mm	d ₂ mm	⚖️ kg
18.315.040.08	40	70	M8	13	-
18.315.040.10		80	M10	18	-
18.315.040.12		80	M12	21	-
18.315.050.08	50	70	M8	13	-
18.315.050.10		80	M10	18	-
18.315.050.12		80	M12	21	-
18.315.050.16		80	M16	29	-
18.315.063.08	63	70	M8	13	-
18.315.063.10		90	M10	18	-
18.315.063.12		100	M12	21	-
18.315.063.16		100	M16	29	-
18.315.080.12	80	100	M12	21	-
18.315.080.16		100	M16	29	-
18.315.100.12	100	120	M12	21	-
18.315.100.16		120	M16	29	-

REF.	ACCESSORIES / ZUBEHÖR
06.315	Front contact extensions for modular tools. / Stirnverlängerung für Einschraubfräser.
06.315	Front contact reducers for modular tools. / Stirnreduzierhülsen für Einschraubfräser.



06.315



06.315

For more information see page / Für weitere Informationen siehe Seite: J.02, J.03

10
DIN 208011 13
DIN 69871-A16
HSK DIN 69893-117
TS ISO 26622-118
PSC ISO 26623-1

MILLING CHUCK

FRÄSDORN

PSC ISO 26623-1

18.400

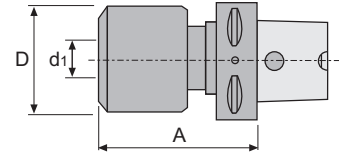



REF.	PSC	A mm	d ₁ mm	D mm	kg
18.400.063.20	63	93	20	54	-
18.400.080.20	80	89	32	72	-
18.400.080.32		101	32	72	-
18.400.100.32	100	120	32	72	-

COMPLEMENTS (Collets type C) / ZUBEHÖR (Spannzangen typ C)

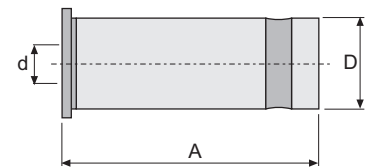
REF.	d mm	D mm	A mm
C2006	6	20	55
C2008	8	20	55
C2010	10	20	55
C2012	12	20	55
C2016	16	20	55
C3206	6	32	65
C3208	8	32	65
C3210	10	32	65
C3212	12	32	65
C3216	16	32	65
C3220	20	32	65
C3225	25	32	65

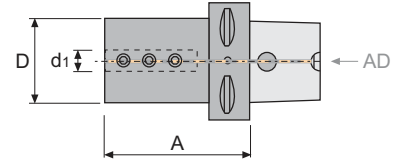



REF.	PSC	A mm	d ₁ mm	D mm		
18.406.040.08	40	50	08	44	14206	-
18.406.040.10		50	10	44	14208	-
18.406.040.12		50	12	44	14208	-
18.406.040.16		50	16	44	14210	-
18.406.050.08	50	52	08	44	14206	-
18.406.050.10		52	10	44	14208	-
18.406.050.12		52	12	44	14208	-
18.406.050.16		52	16	44	14210	-
18.406.050.20		52	20	50	14210	-
18.406.050.25		60	25	55	14210	-
18.406.063.08	63	60	08	44	14206	-
18.406.063.10		60	10	44	14208	-
18.406.063.12		60	12	44	14208	-
18.406.063.16		60	16	44	14210	-
18.406.063.20		60	20	50	14210	-
18.406.063.25		72	25	55	14210	-
18.406.063.32		75	32	55	14210	-
18.406.063.40		85	40	65	14210	-
18.406.080.16	80	85	16	44	14210	-
18.406.080.20		85	20	50	14210	-
18.406.080.25		85	25	55	14210	-
18.406.080.32		85	32	72	14310	-
18.406.080.40		95	40	65	14310	-
18.406.080.50		100	50	75	14310	-
18.406.100.16	100	100	16	44	14210	-
18.406.100.20		100	20	50	14210	-
18.406.100.25		100	25	55	14210	-
18.406.100.32		100	32	55	14310	-
18.406.100.40		110	40	65	14310	-
18.406.100.50		120	50	75	14310	-

18
PSC ISO 26623-1

20 23
JIS B 6339-BT

25
CHIRON

BORING HEADS
BOHRKÖPFE

MORSE SHANKS
MORSE SCHÄFTE

CYLINDRICAL SHANKS
ZYLINDRISCHE SCHÄFTE



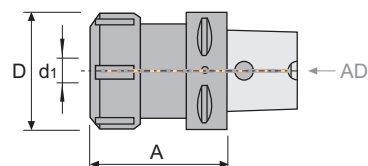

ACCESSORIES
ZUBEHÖR



* If you want with ball bearing nut, see page: K.22

* Wenn Sie diese mit Kugellager-Nute möchten, siehe Seite: K.22

* SUPPLIED WITHOUT WRENCH / * GELIEFERT OHNE SCHLÜSSEL

REF.	PSC		A mm	d ₁ mm	D mm			
18.453.040.16	40	ER16	60	0,5-10	28	45316	50216	-
18.453.040.20		ER20	60	1-13	34	45320	50220	-
18.453.040.25		ER25	60	1-16	42	45325	50225	-
18.453.040.32		ER32	60	2-20	50	45332	50232	-
18.453.050.16	50	ER16	60	0,5-10	28	45316	50216	-
18.453.050.16/100		ER16	100	0,5-10	28	45316	50216	-
18.453.050.20		ER20	60	1-13	34	45320	50220	-
18.453.050.20/100		ER20	100	1-13	34	45320	50220	-
18.453.050.25		ER25	60	1-16	42	45325	50225	-
18.453.050.25/100		ER25	100	1-16	42	45325	50225	-
18.453.050.32		ER32	60	2-20	50	45332	50232	-
18.453.050.32/100		ER32	100	2-20	50	45332	50232	-
18.453.050.40	63	ER40	65	3-30	63	45340	50240	-
18.453.050.40/100		ER40	100	3-30	63	45340	50240	-
18.453.063.16		ER16	60	0,5-10	28	45316	50216	-
18.453.063.16/100		ER16	100	0,5-10	28	45316	50216	-
18.453.063.20	80	ER20	60	1-13	34	45320	50220	-
18.453.063.20/100		ER20	100	1-13	34	45320	50220	-
18.453.063.25		ER25	60	1-16	42	45325	50225	-
18.453.063.25/100		ER25	100	1-16	42	45325	50225	-
18.453.063.32		ER32	60	2-20	50	45332	50232	-
18.453.063.32/100		ER32	100	2-20	50	45332	50232	-
18.453.063.40		ER40	70	3-30	63	45340	50240	-
18.453.063.40/120		ER40	120	3-30	63	45340	50240	-
18.453.080.32	100	ER32	70	2-20	50	45332	50232	-
18.453.080.32/160		ER32	160	2-20	50	45332	50232	-
18.453.100.40		ER40	100	3-30	63	45340	50240	-
18.453.100.40/160		ER40	160	3-30	63	45340	50240	-
18.453.100.32	100	ER32	100	2-20	50	45332	50232	-
18.453.100.32/160		ER32	160	2-20	50	45332	50232	-
18.453.100.40		ER40	100	3-30	63	45340	50240	-
18.453.100.40/160		ER40	160	3-30	63	45340	50240	-
18.453.100.50		ER50	100	6-34	78	45350	50250	-
18.453.100.50/160	ER50	160	6-34	78	45350	50250	-	

REF.	ACCESSORIES / ZUBEHÖR
ERXX	Collets double slot DIN 6499 - Form B (ER) / Spannanzgen mit Doppelnut DIN 6499 - Form B (ER)
ERCXX	Sealed collets DIN 6499 (ER) / Abgedichtete Spannanzgen DIN 6499 (ER)
ERTXX	Collets DIN 6499 - Form Mexin (ER) / Spannanzgen DIN 6499 - Form Mexin (ER)
40.453..	Collet chucks for DIN 6499 (ER) collets / Spannanzgenfutter für DIN 6499 (ER) Spannanzgen
40.455..	Long collet chucks for DIN 6499 (ER) collets / Lange Spannanzgenfutter für DIN 6499 (ER) Spannanzgen



ERXX



ERCXX



ERTXX



40.453..



40.455..

For more information see page / Für weitere Informationen siehe Seite: K.13, K.17, K.19, J.08, J.09

WITH "MINI" COLLET NUT
MIT "MINI"-SPANNMUTTER

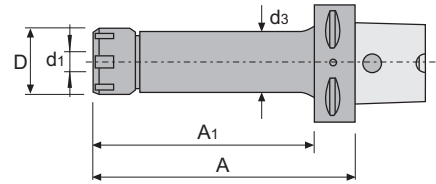

REF.	PSC		d ₁ mm	A mm	D mm	A ₁ mm	d ₃ mm				
18.455.063.16	63	ER16	0,5-10	60	22	-	-	45516	50916	19210	0,785
18.455.063.16/100		ER16	0,5-10	100	22	78	30	45516	50916	19210	0,875
18.455.063.20		ER20	1-13	60	28	-	-	45520	50920	19212	0,795
18.455.063.20/100		ER20	1-13	100	28	78	30	45520	50920	19212	0,945

* SUPPLIED WITHOUT WRENCH / * GELIEFERT OHNE SCHLÜSSEL

REF.	ACCESSORIES / ZUBEHÖR
ERXX	Collets double slot DIN 6499 - Form B (ER) / Spannzangen mit Doppelnut DIN 6499 - Form B (ER)
ERCXX	Sealed collets DIN 6499 (ER) / Abgedichtete Spannzangen DIN 6499 (ER)
ERTXX	Collets DIN 6499 - Form Mexin (ER) / Spannzangen DIN 6499 - Form Mexin (ER)

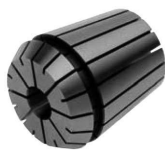

ERXX



ERCXX



ERTXX

For more information see page / Für weitere Informationen siehe Seite: K.13, K.17, K.19

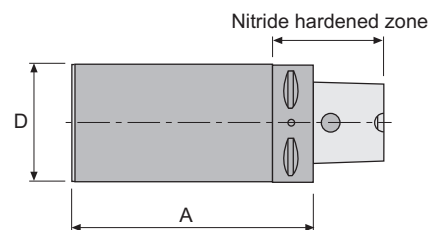

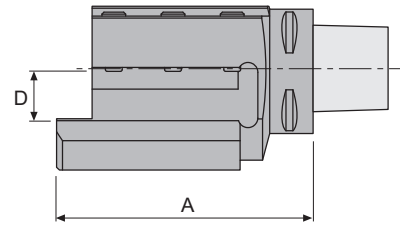

REF.	PSC	D mm	A mm	kg
18.470.032.032/090	32	32	90	-
18.470.032.040/110		40	110	-
18.470.032.050/125		50	125	-
18.470.032.060/090		60	90	-
18.470.032.070/060		70	60	-
18.470.032.090/070		90	70	-
18.470.040.040/095	40	40	95	-
18.470.040.040/120		40	120	-
18.470.040.060/165		60	165	-
18.470.040.080/075		80	75	-
18.470.040.080/120		80	120	-
18.470.040.100/085		100	85	-
18.470.050.050/125	50	50	125	-
18.470.050.050/150		50	150	-
18.470.050.063/180		63	180	-
18.470.050.075/175		75	175	-
18.470.050.090/080		90	80	-
18.470.050.095/150		95	150	-
18.470.050.110/090		110	90	-
18.470.063.063/180	63	63	180	-
18.470.063.075/195		75	195	-
18.470.063.110/120		110	120	-
18.470.063.110/085		110	85	-
18.470.063.120/180		120	180	-
18.470.063.130/095		130	95	-
18.470.080.080/200	80	80	200	-
18.470.080.100/200		100	200	-
18.470.080.120/160		120	160	-
18.470.080.130/090		130	90	-
18.470.080.145/200		145	200	-
18.470.080.150/200		150	200	-
18.470.080.160/120		160	120	-
18.470.100.100/100	100	100	100	-
18.470.100.100/200		100	200	-
18.470.100.150/100		150	100	-
18.470.100.150/200		150	200	-
18.470.100.160/150		160	150	-
18.470.100.200/100		200	100	-



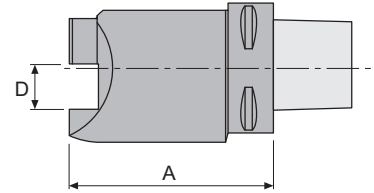

REF.	PSC	Type / Typ	D mm	A mm	kg
18.500.050.20 R/L	50	Turning toolholder for square tool left/right hand.	20	98	-
18.500.063.20 R/L	63			100	-
18.500.063.25 R/L		Drehen Werkzeughalter für Vierkantmeißel links / rechts.	25	130	-
18.500.063.32 R/L			32	134	-
18.500.080.32 R/L	80		32	140	-
18.500.100.32 R/L	100		32	150	-

REF.	3 x 	
18.500.050.20 R/L	17010	29708
18.500.063.20 R/L	17110	29708
18.500.063.25 R/L	17012	29708
18.500.063.32 R/L	17012	29708
18.500.080.32 R/L	17012	29710
18.500.100.32 R/L	17012	29710



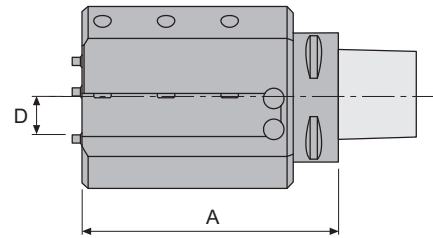

REF.	PSC	Type / Typ	D mm	A mm	
18.510.050.20 R/L	50	Turning toolholder for square tool left/right hand.	20	100	-
18.510.063.20 R/L	63		20	100	-
18.510.063.25 R/L		Drehen Werkzeughalter für Vierkantmeißel links / rechts.	25	130	-
18.510.080.32 R/L	80		32	135	-
18.510.100.32 R/L	100		32	145	-

REF.		
18.510.050.20 R/L	17110	29708
18.510.063.20 R/L	17110	29708
18.510.063.25 R/L	17012	29708
18.510.080.32 R/L	17012	29710
18.510.100.32 R/L	17012	29710



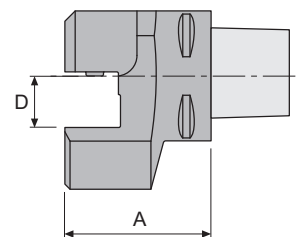

REF.	PSC	Type / Typ	D mm	A mm	kg
18.520.050.20 R/L	50	Multipurpose square toolholder.	20	100	-
18.520.063.20 R/L	63		20	125	-
18.520.063.25 R/L		Multipurpose Vierkant Werkzeughalter.	25	130	-
18.520.080.32 R/L	80		32	150	-
18.520.100.32 R/L	100		32	160	-

REF.		
18.520.050.20 R/L	17012	29708
18.520.063.20 R/L	17012	29708
18.520.063.25 R/L	17012	29708
18.520.080.32 R/L	17012	29710
18.520.100.32 R/L	17012	29710



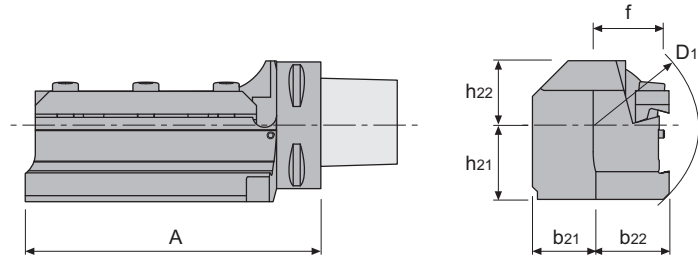

REF.	PSC	Type / Typ	D mm	A mm	
18.530.050.20	50	Multipurpose square toolholder.	20	58	-
18.530.063.20	63	Multipurpose Vierkant Werkzeughalter.	20	60	-
18.530.063.25			25	71	-
18.530.063.32			32	71	-
18.530.080.32	80		32	85	-
18.530.100.32	100		32	90	-

REF.		
18.530.050.20	17112	29708
18.530.063.20	17112	29708
18.530.063.25	17012	29708
18.530.063.32	17012	29708
18.530.080.32	17012	29710
18.530.100.32	17012	29710



REF.	PSC	D ₁ mm	b ₂₁ mm	b ₂₂ mm	f mm	h ₂₁ mm	h ₂₂ mm	A mm	⚖️ kg
18.540.050.26 R/L	50	87	25.5	31.0	26.0	30.0	26.0	95	1,500
18.540.063.32 R/L	63	106	32.0	37.0	32.0	38.0	32.0	147	3,300
18.540.080.32 R/L	80	122	40.0	45.5	40.5	40.5	40.5	155	5,200
18.540.100.32 R/L	100	160	50.0	55.5	50.5	60.5	50.0	175	-
18.540.100.52 R/L		180	50.0	55.5	50.5	65.5	50.0	300	-

REF.		
18.540.050.26 R/L	80526	11308
18.540.063.32 R/L	80632	11308
18.540.080.32 R/L	80632	11308
18.540.100.32 R/L	80632	11308
18.540.100.52 R/L	81052	11308

18
PSC ISO 26623-1

20 23
JIS B 6339-BT

25
CHIRON

BORING HEADS
BOHRKÖPFE

MORSE SHANKS
MORSE SCHÄFTE

CYLINDRICAL SHANKS
ZYLINDRISCHE SCHÄFTE

ACCESSORIES
ZUBEHÖR

10
DIN 208011 13
DIN 69871-A16
HSK DIN 69893-117
TS ISO 26622-118
PSC ISO 26623-1

RADIAL HOLDER

RADIAL-WERKZEUGHALTER

PSC ISO 26623-1



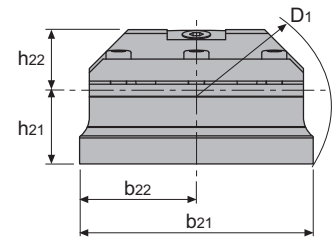
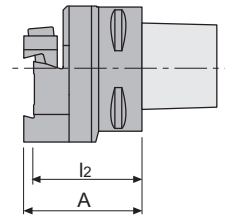

18.550

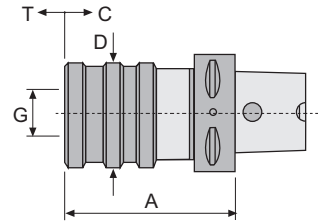

REF.	PSC	D ₁ mm	b ₂₁ mm	b ₂₂ mm	h ₂₁ mm	h ₂₂ mm	A mm	l ₂ mm	 kg
18.550.050.26	50	100	80	40.0	30.0	25.2	58	53	1,300
18.550.063.32	63	141	120	60.0	37.0	32.0	60	55	2,300
18.550.080.32	80	145	120	60.0	40.5	40.0	68	63	3,500
18.550.100.32	100	145	120	60.0	40.5	40.0	83	78	-
18.550.100.52		165	135	67.5	65.5	50.0	83	78	-

REF.		
18.550.050.26	80526	11308
18.550.063.32	81632	11308
18.550.080.32	81632	11308
18.550.100.32	81632	11308
18.550.100.52	81052	11308



REF.	PSC	G N ^o . Ø		A mm	D mm	C mm	T mm			
18.620.040.12	40	1 19	M3-M12	65	38	9	9	710XX	750XX	-
18.620.050.12	50	1 19	M3-M12	65	38	9	9	710XX	750XX	-
18.620.063.12	63	1 19	M3-M12	70	38	9	9	710XX	750XX	-
18.620.063.20		2 31	M8-M20	95	55	15	15	720XX	760XX	-
18.620.063.33		3 48	M14-M33	140	79	24	24	730XX	770XX	-
18.620.080.12	80	1 19	M3-M12	80	38	9	9	710XX	750XX	-
18.620.080.20		2 31	M8-M20	100	55	15	15	720XX	760XX	-
18.620.080.33		3 48	M14-M33	150	79	24	24	730XX	770XX	-
18.620.100.12	100	1 19	M3-M12	90	38	9	9	710XX	750XX	-
18.620.100.20		2 31	M8-M20	110	55	15	15	720XX	760XX	-
18.620.100.33		3 48	M14-M33	160	79	24	24	730XX	770XX	-

COMPENSATION IN COMPRESSION (C) AND TENSION (T)
 AUSGLEICH DER KOMPRESSION (C) UND DER TRAKTION (T)

REF.	ACCESSORIES / ZUBEHÖR
710XX..730XX	Quick change adapters without overload clutch / Schnellwechseleinsätze ohne Sicherheitskupplung
750XX..770XX	Quick change adapters with overload clutch / Schnellwechseleinsätze mit Sicherheitskupplung



710XX..730XX



750XX..770XX

For more information see page / Für weitere Informationen siehe Seite: K.06, K.07

10
DIN 208011 13
DIN 69871-A16
HSK DIN 69893-117
TS ISO 26622-118
PSC ISO 26623-1

CONTROL PINS

PRÜFDORNE

PSC ISO 26623-1

18.999

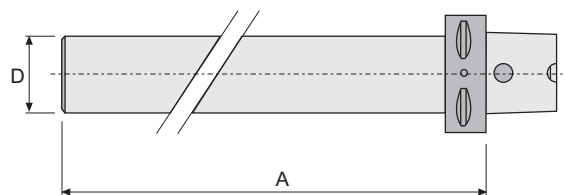

REF.	PSC	A	D	 Kg
18.999.050	50	300	40	-
18.999.063	63	300	40	-
18.999.080	80	300	50	-
18.999.100	100	300	50	-

1 TYPE / TYP

18.160 	18.180 	18.215 	18.296 	18.306
18.315 	18.400 	18.406 	18.453 	18.455
18.470 	18.500 	18.510 	18.520 	18.530
18.540 	18.550 	18.620 		

2 DIMENSION / ABMESSUNG

32	40	50	63	80	100
-----------	-----------	-----------	-----------	-----------	------------

3 LENGTH (A) / LÄNGE (A)

<p style="text-align: center;">A</p>	<hr/> <hr/> <hr/> <hr/> <hr/> <hr/>
--------------------------------------	-------------------------------------

DIAMETER / DURCHMESSER	MK	ISO	COLLET SPANNZANGE
<p style="text-align: center;">D</p>	<p style="text-align: center;">MK</p>	<p style="text-align: center;">ISO</p>	

NOTES:
